

AK-22 Quick Installation Guide (EN)

PRIOR to USE

Install the mount onto a strong structure such as concrete wall

Use the supplied accessories when installing the mount bracket depends on mounting position

DIMENSION (Unit: mm)

SPECIFICATION

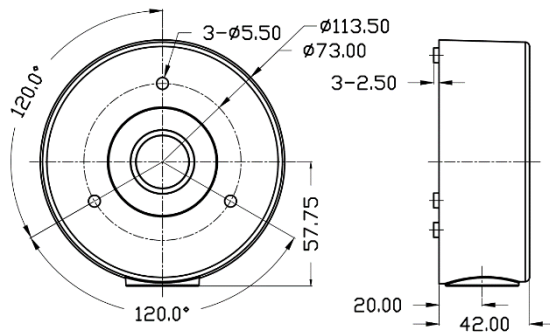

Construction: Aluminum Cast

Environment: Ceiling Mount

Dimension(mm): $\phi 113.5 \times 44.0$ mm

Weight: 239g (0.53lb)

PARTS SUPPLIED

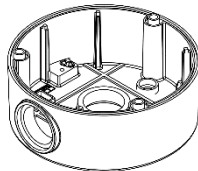

Junction Box

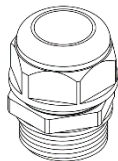

Waterproof Stopper

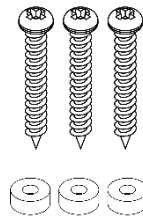

Screws, Water-proof Rubber

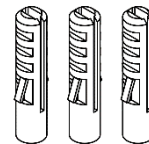

3 x Expansion Bolt



3 x Screws

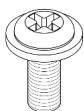

Screw

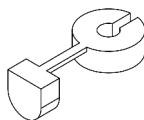

Stopper For Wire

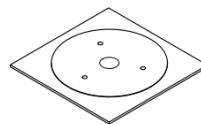

Installation Template



QIG

INSTALLATION

● Ceiling Mount

1. Locate the mounting template at the installation position and drill the wall.
2. Hammer the 3 expansion screws into the wall holes drilled
3. Route the power and BNC cable through the bracket
4. Tight the box to wall through the three screws
5. Insert the box ring to the mounting plate for waterproofing
6. Open the dome cover by loosening screws
7. Connect the power and BNC cable with the camera cables
8. Assemble the vandal proof dome base to the mounting plate using the assembly screws
9. Set the camera's viewing angle
10. Put the dome cover to the dome unit and tighten screws.

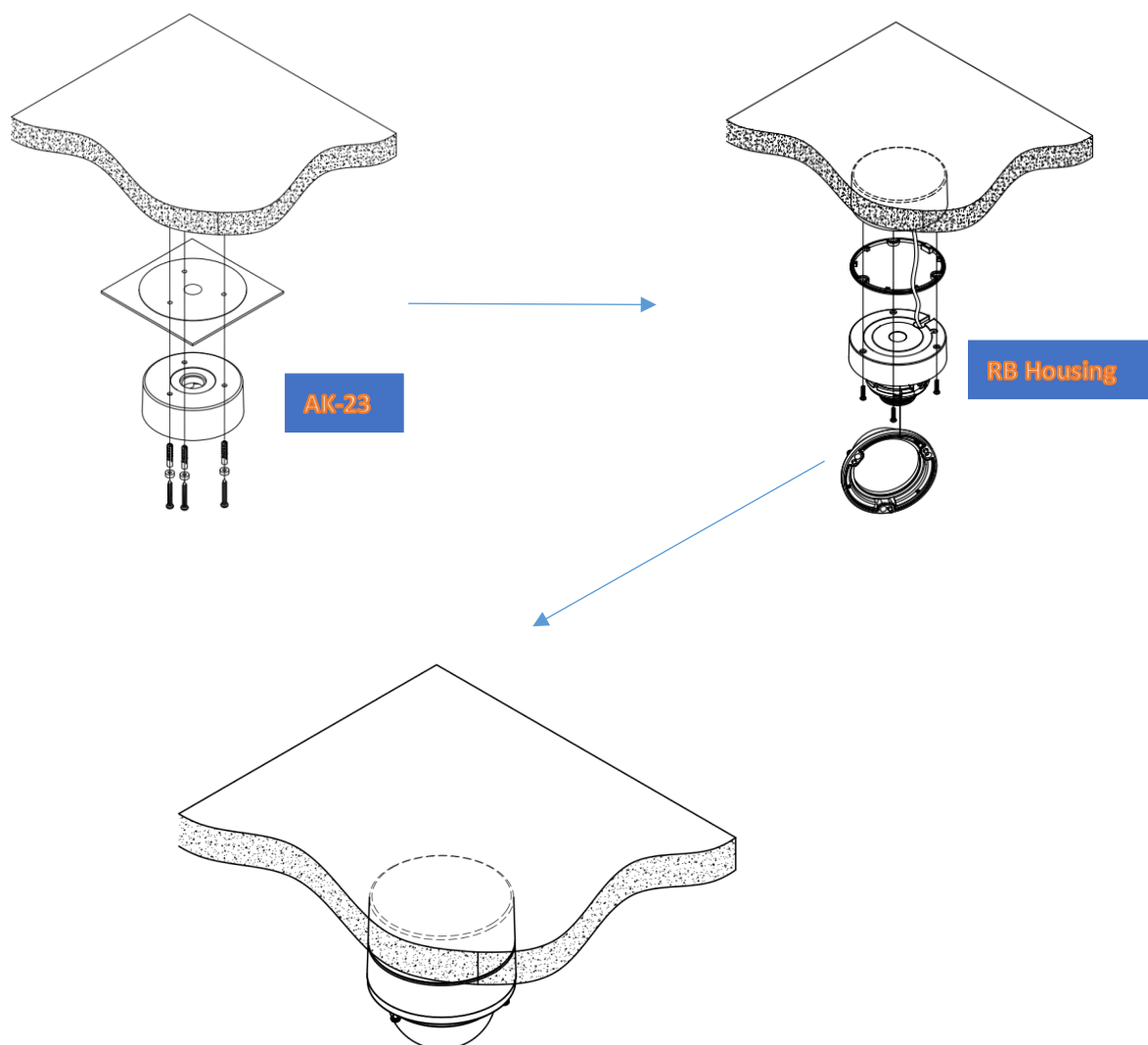

● Wall Mount

Details operation steps please refer to the above-mentioned **Ceiling Mount**.

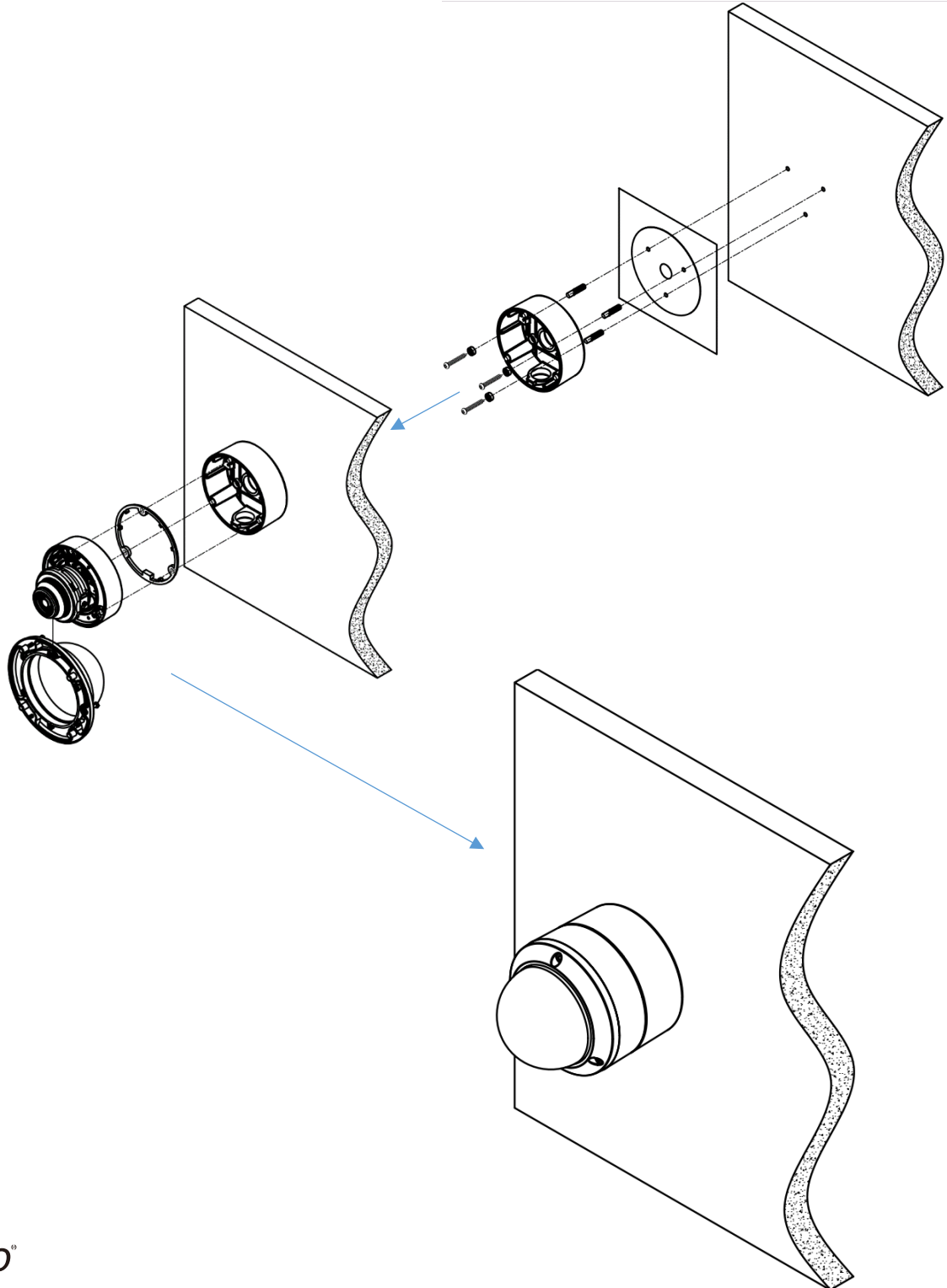

eneo® is a registered trademark of
VIDEOR E. Hartig GmbH
Exclusive distribution through
specialised trade channels only.

VIDEOR E. Hartig GmbH
Carl-Zeiss-Straße 8
63322 Rödermark/Germany
Tel. +49 (0) 6074 / 888-0
Fax +49 (0) 6074 / 888-100
www.videor.com
www.eneo-security.com

Technical changes reserved
© Copyright by VIDEOR E. Hartig
GmbH Version 08/2022