

# DOME-WB1 B for Vandalproof dome

## INSTALLATION GUIDE

### PRIOR to USE

Install the mount onto a strong structure such as concrete wall. Use the supplied accessories when installing the mount bracket depends on mounting position.

### SPECIFICATION

Construction: Aluminum cast  
 Environment: Wall mount for a Vandalproof dome  
 Dimension(mm): Ø141.4(W)x183(H)x252.7(L)  
 Weight: 1 kg (2.2 lb)

### DIMENSION

(unit: mm)

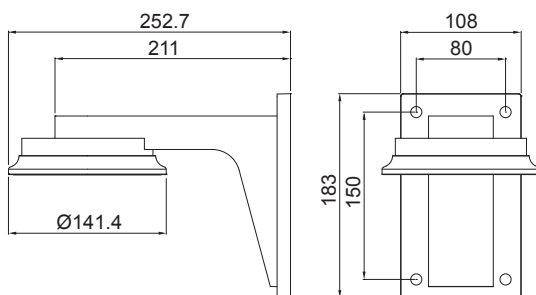

### APPLICATION

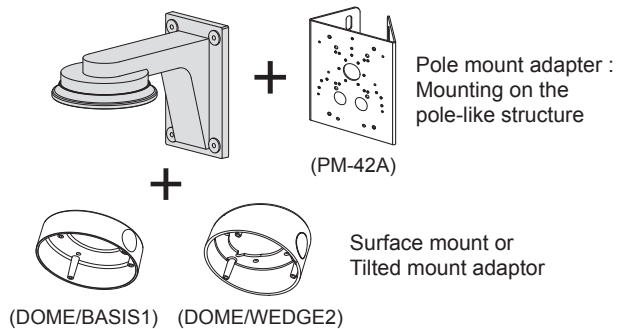

### PARTS SUPPLIED

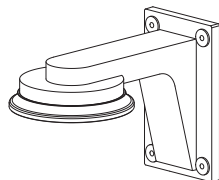

Wall Mount Bracket

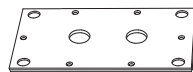

Rear-Plate (Q'ty:1)

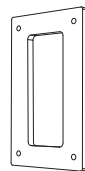

Plastic Plate (Q'ty:1)

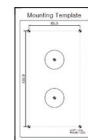

Mounting  
Template

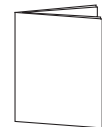

Installation  
Guide



SUS Bushing (Q'ty:4)



Cable Grommet (Q'ty:2)



Mounting Screw  
M5x50mm (Q'ty:4)



L-Wrench  
3mm(Q'ty:1)



Plastic Anchor  
8x35mm (Q'ty:4)



L-Wrench  
5mm (Q'ty:1)

#### Assembly Screw : for main bracket



M3x12mm (Q'ty:4)



M4x12mm (Q'ty:4)  
Screwed in Mount-Plate



M3x8mm (Q'ty:6)

#### Mounting Screw : for Pole mount adaptor



M6x30mm (Q'ty:4)



Spring Washer (Q'ty:4)

## INSTALLATION

1. Locate the mounting template at the installation position and drill the wall.
2. Remove the release paper of plastic plate and attach to rear plate of the bracket.
3. Route the power and BNC/LAN cables through bracket plates and grommets as illustrated.
4. Place the mount bracket on pre-drilled position and fix it through using mounting screws.

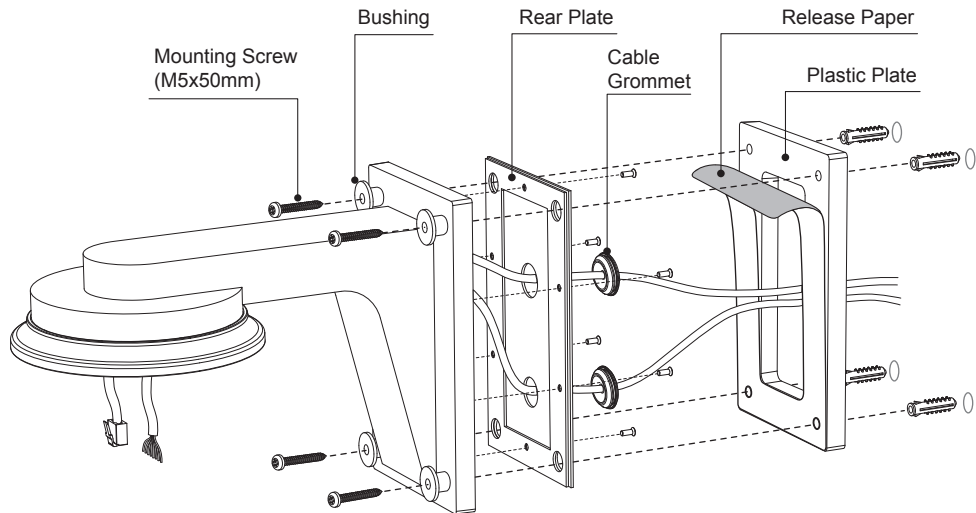

5. Open the dome cover by loosening screws.
6. Affix the surface mount adaptor to the mount plate using the assembly screws (M3x12mm).  
Assemble vandalproof dome flushmount unit to the surface mount adaptor.
7. Set the camera's viewing angle and adjust zoom&focus.
8. Put the dome cover to the dome unit and tighten screws.

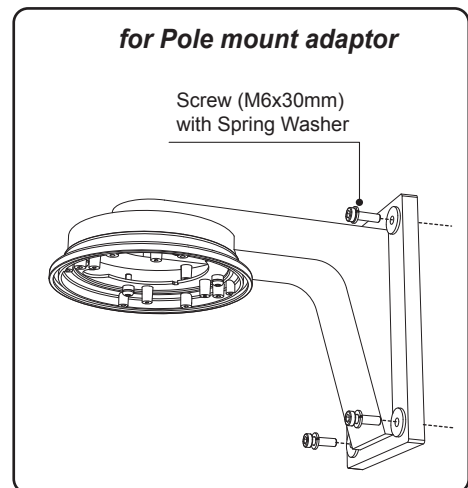
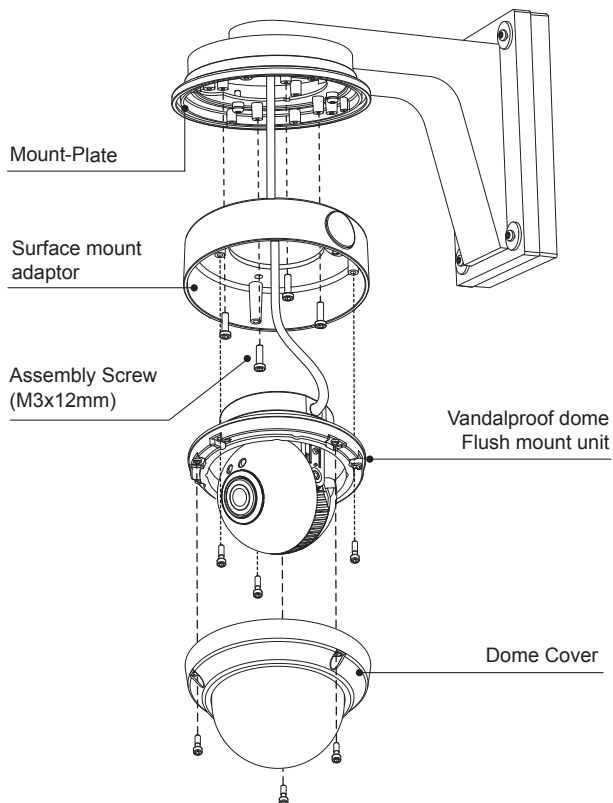

\* The vandalproof dome and surface mount adaptor are not included in this package.